

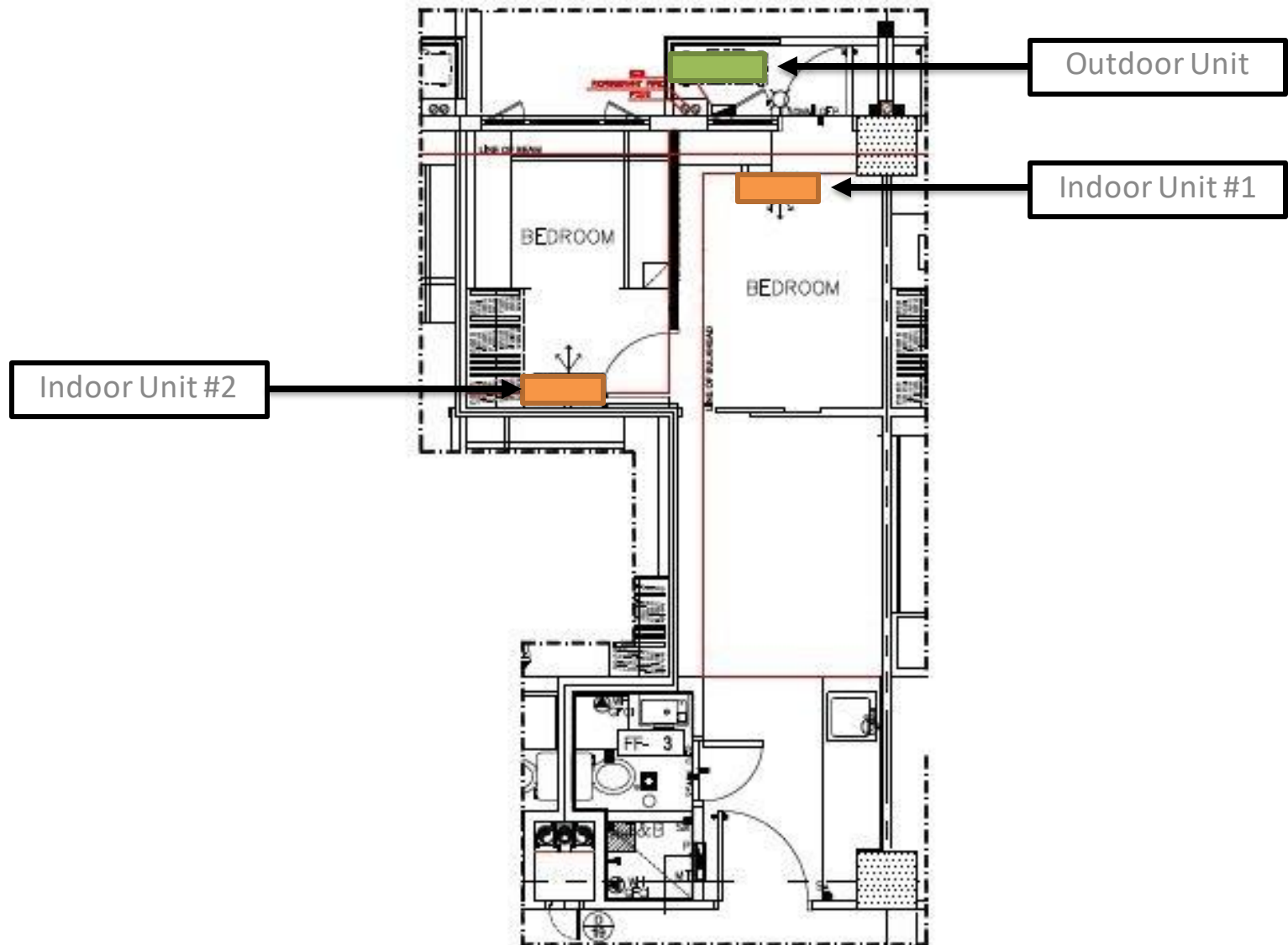

ACU Installation Guidelines

Indoor / Outdoor Units Mounting Locations



Unit Type 1

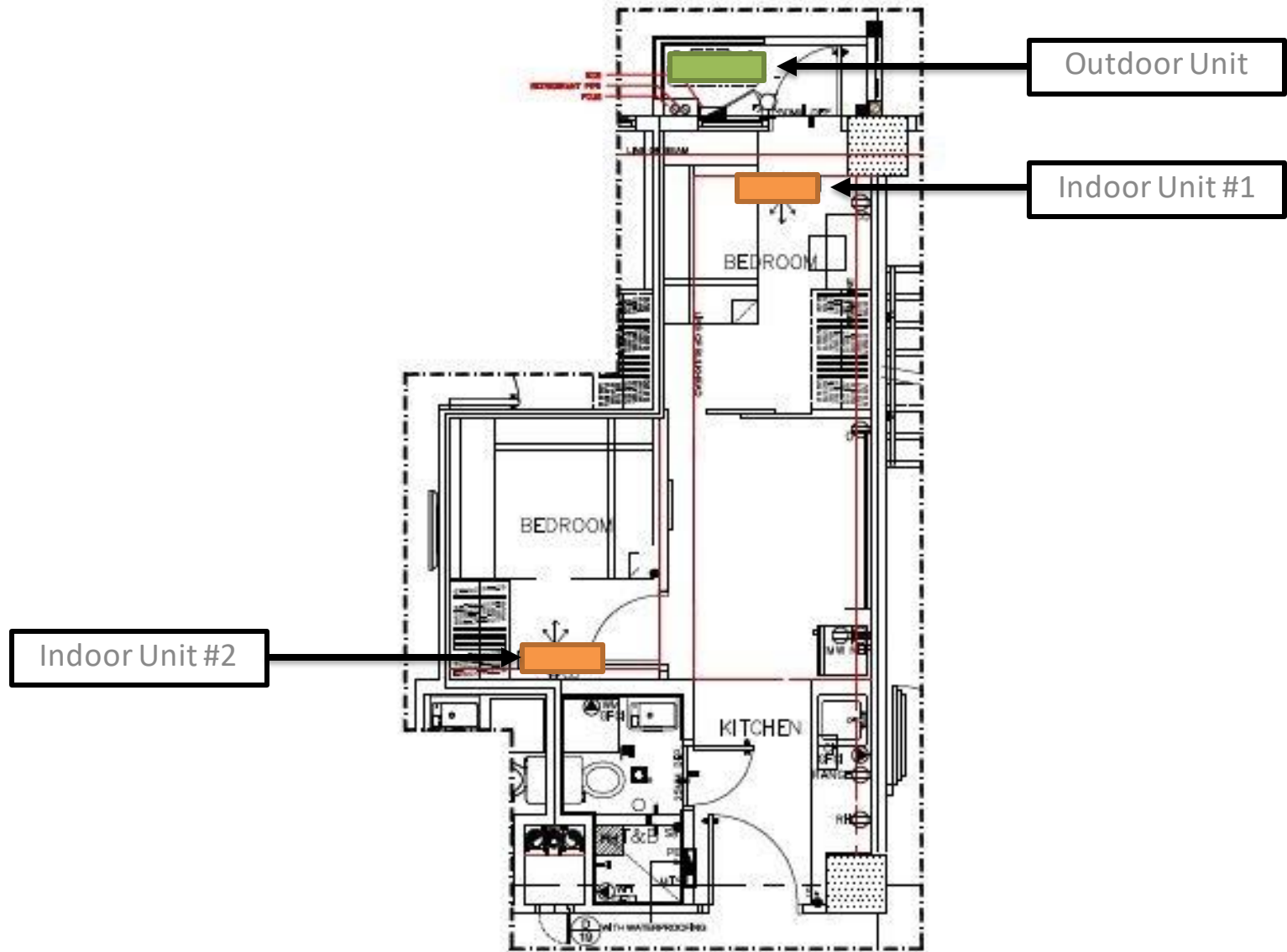

Unit Type 2

Operable Bulkhead / Tapping Point Locations

Operable
False Column



Operable
Bulkhead for
Indoor Unit #1

Operable
Bulkhead for
Indoor Unit #2

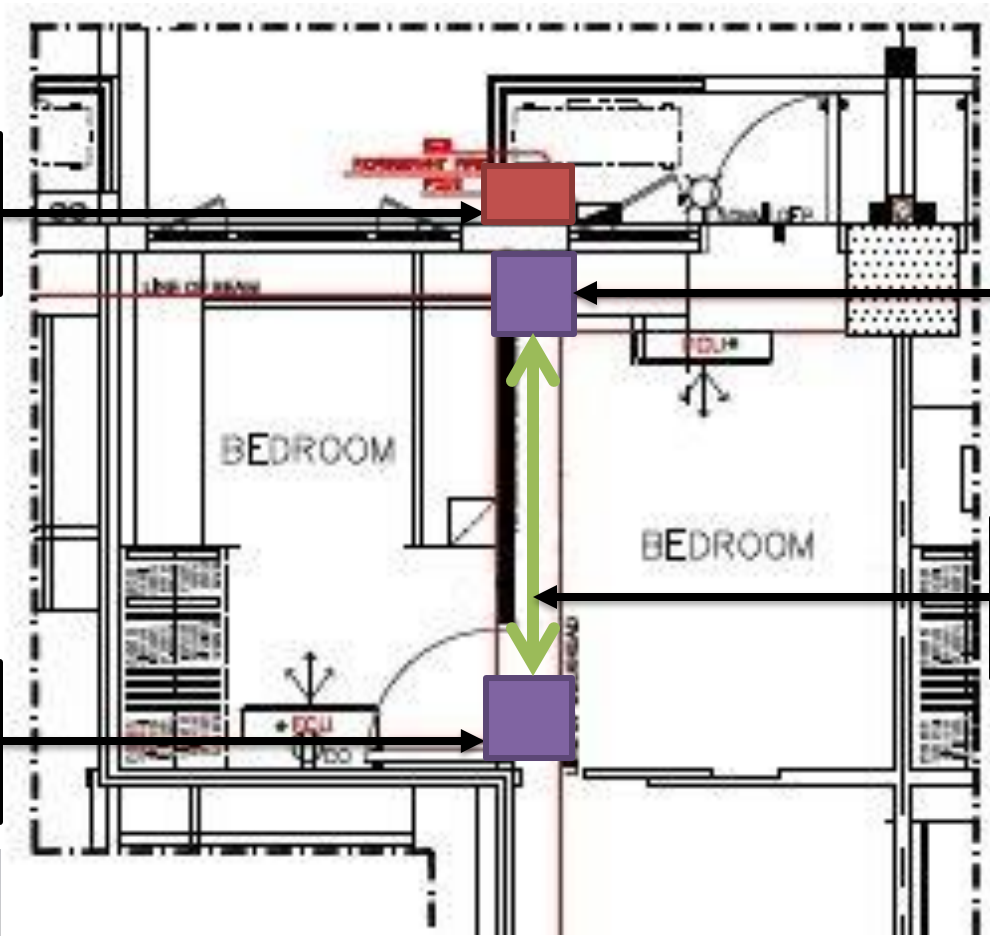

Refrigerant
Piping c/o Unit
Owner

Unit Type 1

Operable
False Column



Operable
Bulkhead for
Indoor Unit #1

Refrigerant
Piping c/o Unit
Owner



Operable
Bulkhead for
Indoor Unit #2

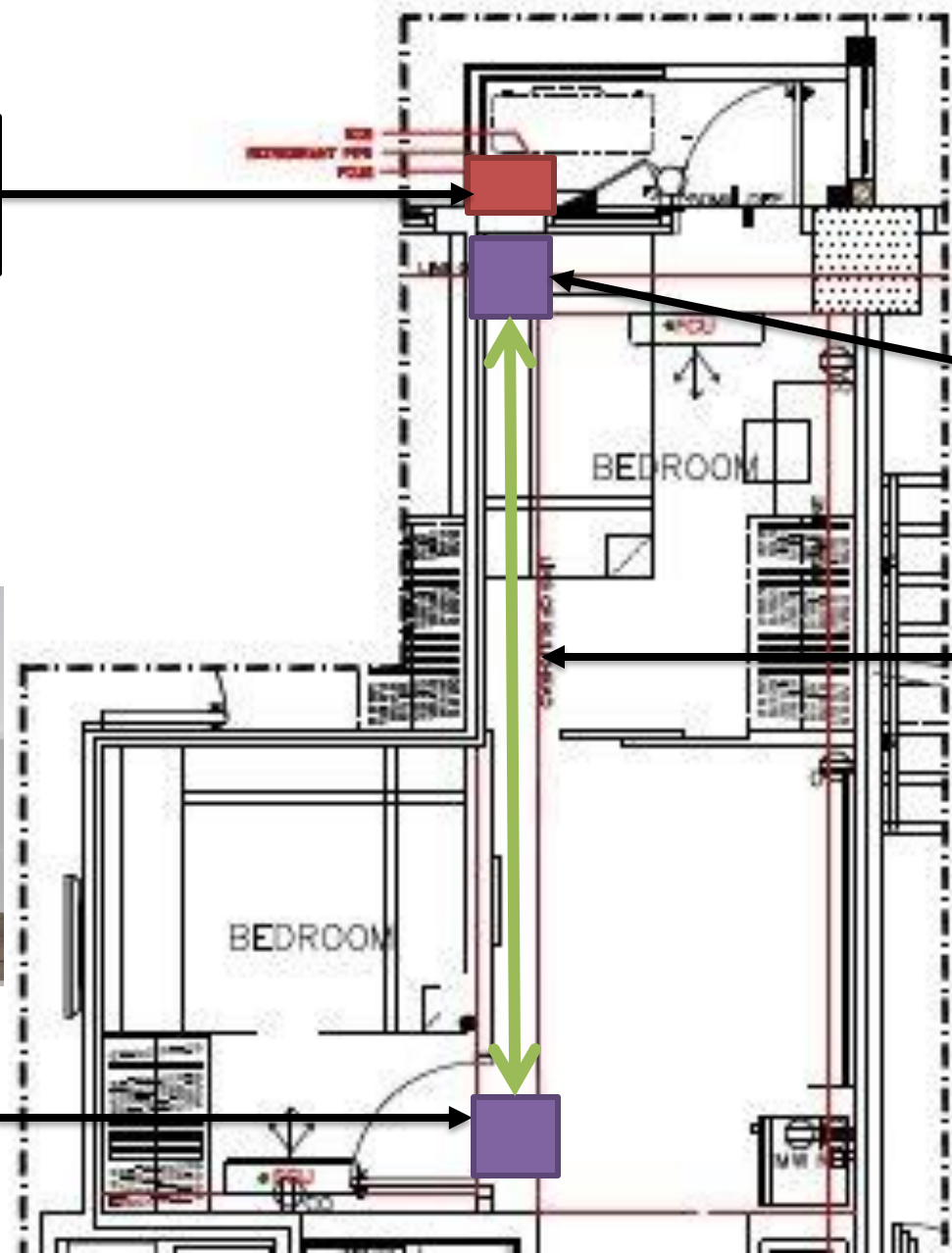

Unit Type 2

Operable False Column

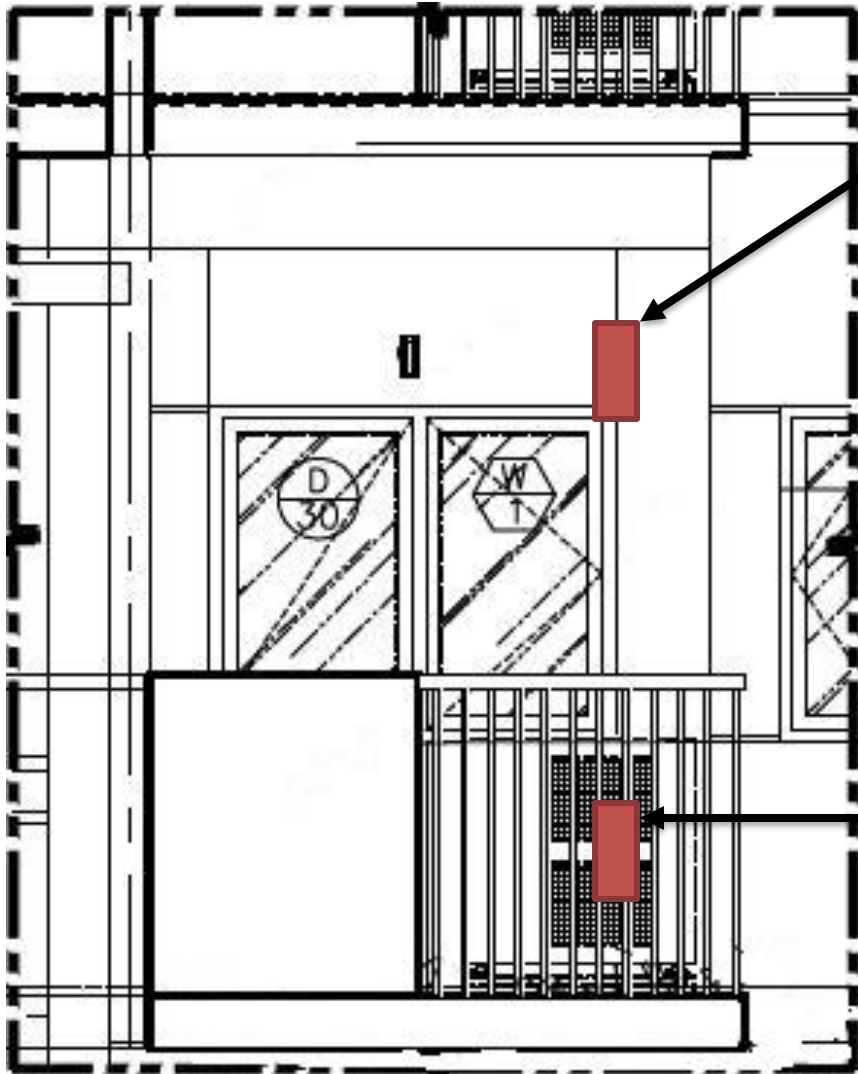

Operable
False Column
(Top
Provision)



Operable
False Column
(Bottom
Provision)



Balcony Elevation

How to Access Tapping Point At Bedroom 1



Locate screw caps on surface of bulkhead.



Manually remove exposed screw caps.



Using a Philips head screwdriver, remove exposed screws.



Using a box cutter, trace on the perimeter to expose cover termination.

Push on the board upward to remove cover.

How to Access Tapping Point At Bedroom 2

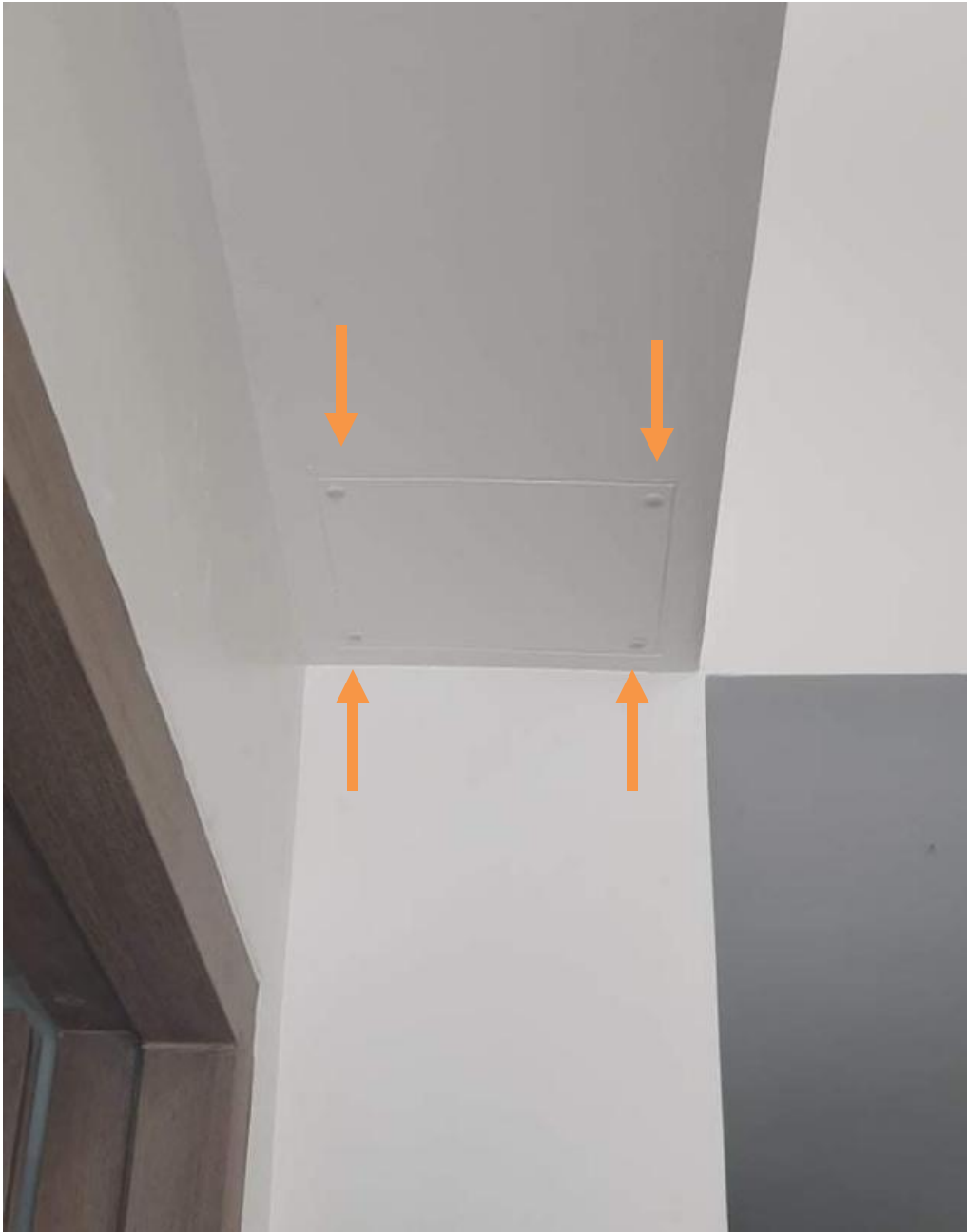

Locate screw caps on surface of bulkhead.



Manually remove exposed screw caps.



Using a Philips head screwdriver,
remove exposed screws.



Using a box cutter, trace on the perimeter to expose cover termination.

Push on the board upward to remove cover.

FAQs

- **What are the needed tools to access bulkhead?**
Philips-head screwdriver and box cutter
- **What materials can be used to reseal the bulkhead once done?**
Perimeter may be retouched with paint
- **Will any utility be affected on the bulkhead provision?**
Fire protection branch line may be present in some bulkheads but will not be affected by installation of refrigerant pipes
- **How can we secure refrigerant pipes inside the dry wall provision?**
This is under scope of AC installer; metal furrings of existing bulkheads can accommodate weight of refrigerant pipes if laid atop it
- **What will be the source of electricity for ACUs**
Source of electricity for ACCU will be the Enclosed Circuit Breaker (ECB-Nema 3R) located at balcony area
- **What is load of outlet provided for ACU**
Ampere rating of ECB is 32 amperes

End of Presentation